

Notes:

S#	Dwg.	CSI NO	DESCRIPTION	QTY.	Wastage	Qty w/ Wastage	UNIT	Unit Labor Cost	Unit Material Cost	Total Labor Cost (A)	Total Material Cost (B)	TOTAL COST (A+B)
		010000	GENERAL REQUIREMNETS									
1			Mobilization	1	0%	1	LS			\$0	\$0	\$0
2			Supervision	1	0%	1	LS			\$0	\$0	\$0
3			Safety requirements	1	0%	1	LS			\$0	\$0	\$0
4			Office overheads	1	0%	1	LS			\$0	\$0	\$0
5			Temporary facilities and controls	1	0%	1	LS			\$0	\$0	\$0
6			Project Closeouts	1	0%	1	LS			\$0	\$0	\$0
7			Submittal and approval	1	0%	1	LS			\$0	\$0	\$0
8			Others	1	0%	1	LS			\$0	\$0	\$0
			Subtotal							\$0	\$0	\$0
		090000	FINISHES									
			Finish Plan-First Floor Area A									
			Bath Wall Tiles									
9			MT-1: Mosaic Tiles Manufacturer: Emser Tile Style/Series: Lucente Color/Finish: Cielo Only;Grout: Mapei 00 White	29	10%	32	SF			\$0	\$0	\$0
10			MT-2: Mosaic Tiles Manufacturer: Emser Tile Style/Series: Lucente Color/Finish: Blanc, Cielo,Morning Fog;Grout: Mapei 00 White	98	10%	108	SF			\$0	\$0	\$0
11			PT-2: Porcelain Tiles Manufacturer: Trinity Tile Style/Series: Foundations Color/Finish: White; Grout: MAPEI #39 Vory	1195	10%	1314	SF			\$0	\$0	\$0
			Floor Finishes									
12			SVF-1: Sheet Vinyl Flooring Manufacturer: Tarkett Style/Series: Accent Flourish Color/Finish: Thrive Connection 207	1261	10%	1388	SF			\$0	\$0	\$0
13			SVF-2: Sheet Vinyl Flooring Manufacturer: Tarkett Style/Series: Accent Flourish Color/Finish: Thrive Stability 206	925	10%	1018	SF			\$0	\$0	\$0
14	A-5.1A		SVF-3: Sheet Vinyl Flooring Manufacturer: Tarkett Style/Series: Accent Flourish Color/Finish: Propser Essence 304	55	10%	60	SF			\$0	\$0	\$0

S#	Dwg.	CSI NO	DESCRIPTION	QTY.	Wastage	Qty w/ Wastage	UNIT	Unit Labor Cost	Unit Material Cost	Total Labor Cost (A)	Total Material Cost (B)	TOTAL COST (A+B)
15			SVF-4: Sheet Vinyl Flooring Manufacturer: Tarkett Style/Series: Acczent Flourish Color/Finish: 30026 Brushed Oak Medium	1875	10%	2062	SF			\$0	\$0	\$0
16			SVF-5: Sheet Vinyl Flooring Manufacturer: Armstrong Style/Series: Medintech Color/Finish: 84163 Almond W/ Diamond 10 Technology	108	10%	119	SF			\$0	\$0	\$0
17			LVT-1: Luxury Vinyl Tile Manufacturer: Mannington Style/Series: Divergent Collection/ Strand Color/Finish: Gossamer	565	10%	621	SF			\$0	\$0	\$0
18			CPT-1: Carpet Manufacturer: Tarkett Style/Series: 04090 Winwood Color/Finish: 59004 Oakmoss	252	10%	277	SF			\$0	\$0	\$0
19			PT-1: Porcelain Tile Manufacturer: Trinity Tile Style/Series: Foundations Color/Finish: Silver; Grout: MAPEI #107 Iron	199	10%	219	SF			\$0	\$0	\$0
			Floor Transition									
20			Floor Transition	122	10%	134	LF			\$0	\$0	\$0
			Finish Plan-First Floor Area B									
			Floor Finishes									
21			SVF-1: Sheet Vinyl Flooring Manufacturer: Tarkett Style/Series: Acczent Flourish Color/Finish: Thrive Connection 207	300	10%	330	SF			\$0	\$0	\$0
22			SVF-5: Sheet Vinyl Flooring Manufacturer: Armstrong Style/Series: Medintech Color/Finish: 84163 Almond W/ Diamond 10 Technology	888	10%	977	SF			\$0	\$0	\$0
23			TER-1: Terrazzo Flooring Manufacturer: Terrazzo & Marble Supply Companies Style/Series: Terroxy Resin System Color/Finish: TM#21-1127	1071	10%	1178	SF			\$0	\$0	\$0
24			TER-2: Terrazzo Flooring Manufacturer: Terrazzo & Marble Supply Companies Style/Series: Terroxy Resin System Color/Finish: TM#21-1129	618	10%	679	SF			\$0	\$0	\$0
25	A-5.1B		TER-3: Terrazzo Flooring Manufacturer: Terrazzo & Marble Supply Companies Style/Series: Terroxy Resin System Color/Finish: TM#21-1128	101	10%	111	SF			\$0	\$0	\$0
26			PT-1: Porcelain Tile Manufacturer: Trinity Tile Style/Series: Foundations Color/Finish: Silver; Grout: MAPEI #107 Iron	96	10%	106	SF			\$0	\$0	\$0
27			LVT-1: Luxury Vinyl Tile Manufacturer: Mannington Style/Series: Divergent Collection/ Strand Color/Finish: Gossamer	653	10%	718	SF			\$0	\$0	\$0

S#	Dwg.	CSI NO	DESCRIPTION	QTY.	Wastage	Qty w/ Wastage	UNIT	Unit Labor Cost	Unit Material Cost	Total Labor Cost (A)	Total Material Cost (B)	TOTAL COST (A+B)
28			LVT-5: Luxury Vinyl Tile Manufacturer: Mannington Style/Series: Nature's Path/Wood Color/Finish: Windsor Oak Chestnut 12233	1134	10%	1248	SF			\$0	\$0	\$0
29			CPT-1: Carpet Manufacturer: Tarkett Style/Series: 04090 Winwood Color/Finish: 59004 Oakmoss	176	10%	194	SF			\$0	\$0	\$0
			Floor Transition									
30			Floor Transition	30	10%	33	LF			\$0	\$0	\$0
			Finish Plan-First Floor Area B2									
			Floor Finishes									
31			TER-1: Terrazzo Flooring Manufacturer: Terrazzo & Marble Supply Companies Style/Series: Terroxy Resin System Color/Finish: TM#21-1127	178	10%	195	SF			\$0	\$0	\$0
32			TER-3: Terrazzo Flooring Manufacturer: Terrazzo & Marble Supply Companies Style/Series: Terroxy Resin System Color/Finish: TM#21-1128	69	10%	76	SF			\$0	\$0	\$0
33	A-5.1B2		MAT-1 Manufacturer: Temser Tile Style/Series: Lucente Color/Finish: Cielo Only; Grout: Mapei 00 White	109	10%	120	SF			\$0	\$0	\$0
34			TER-1,2,3: Terrazzo Flooring Manufacturer: Terrazzo & Marble Supply Companies Style/Series: Terroxy Resin System Color/Finish: TM#21-1127/1128/1129	484	10%	532	SF			\$0	\$0	\$0
			Floor Transition									
35			Floor Transition	7	10%	8	LF			\$0	\$0	\$0
			Subtotal							\$0	\$0	\$0
			TOTAL AMOUNT							\$0	\$0	\$0
			Contingencies (5%)							\$0	\$0	\$0
			Overhead and Profit (15%)							\$0	\$0	\$0
			TOTAL BASE BID							\$0	\$0	\$0

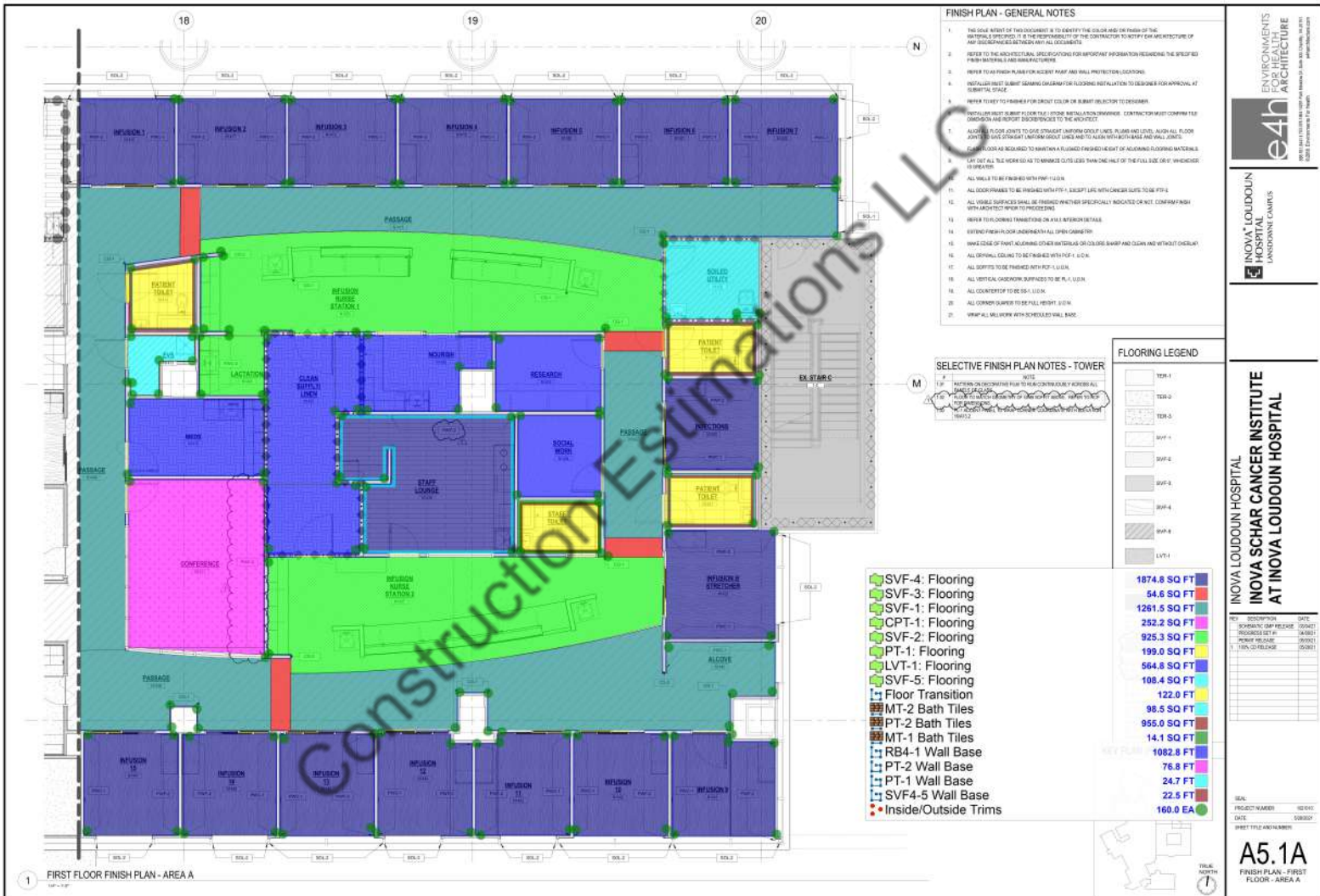

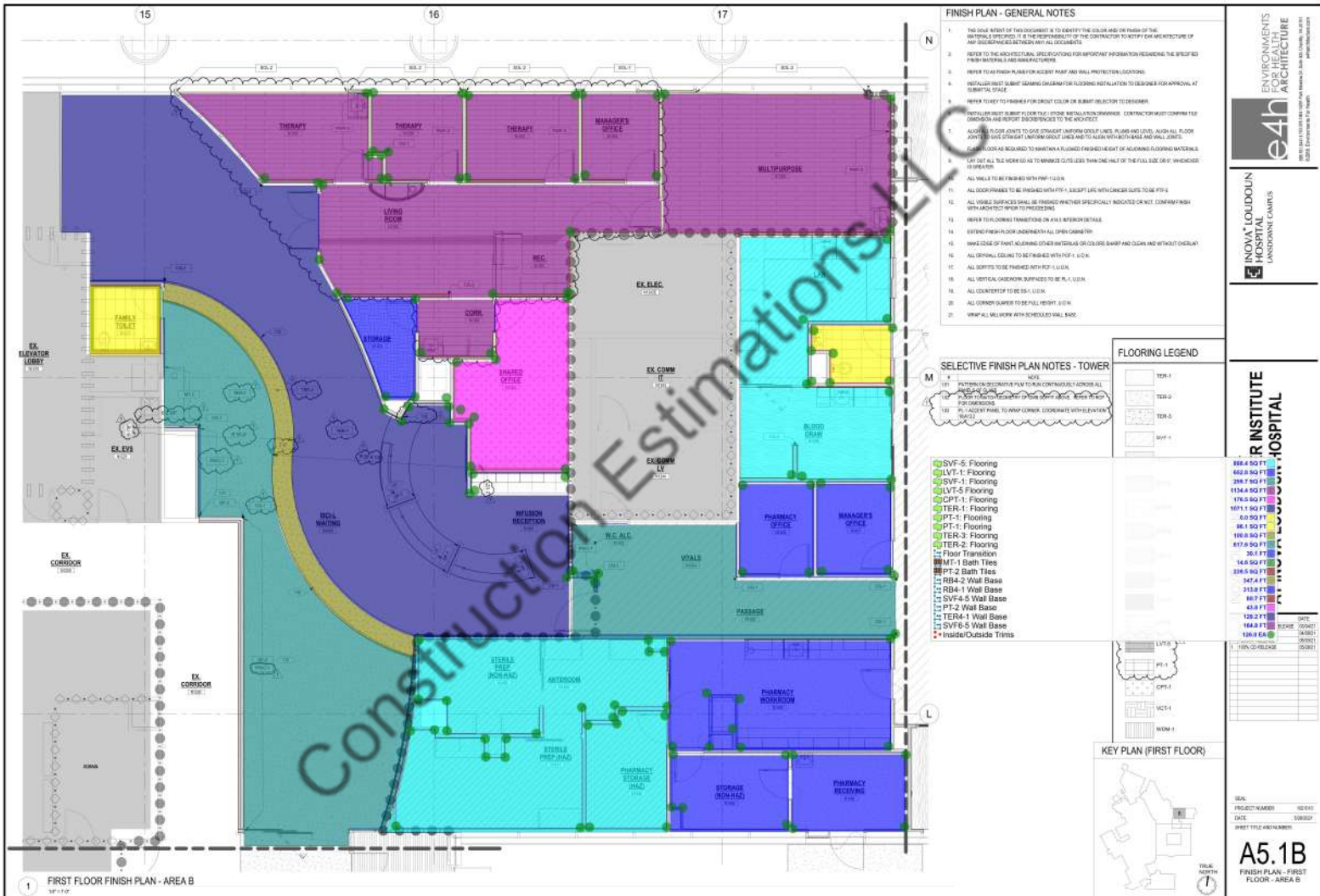

- ### FINISH PLAN - GENERAL NOTES
1. THE GOAL INTENT OF THIS DOCUMENT IS TO DEFINE THE COLOR AND OR FINISH OF THE MATERIALS SPECIFIED. IT IS THE RESPONSIBILITY OF THE CONTRACTOR TO NOTIFY THE ARCHITECTURE OF ANY DISCREPANCIES BETWEEN THE FINISH SCHEDULES.
 2. REFER TO THE ARCHITECTURAL SPECIFICATIONS FOR IMPORTANT INFORMATION REGARDING THE SPECIFIED FINISH MATERIALS AND MANUFACTURERS.
 3. REFER TO THE FINISH PLAN FOR ACCESS PANEL AND WALL PROTECTION LOCATIONS.
 4. INSTALLED LIGHT FIXTURES OR GRATES FOR FLOORING REGULATION TO BE DESIGNER FOR APPROVAL AT SUBMITTAL STAGE.
 5. REFER TO THE FINISH PLAN FOR LIGHT COLOR OR SUBMIT SELECTOR TO DESIGNER.
 6. NOTIFY ARCHITECT IMMEDIATELY FOR ANY DISCREPANCIES. CONTRACTOR MUST CONFIRM THE DIMENSION AND REPORT DISCREPANCIES TO THE ARCHITECT.
 7. ADJUST FLOOR JOISTS TO USE STRAIGHT LAMINATED JOIST PANELS AND LEVEL. ALIGN ALL FLOOR JOISTS TO USE STRAIGHT LAMINATED JOIST PANELS TO MATCH THE JOIST AND PANEL JOINTS. CLEAN FLOORS AS REQUIRED TO MINIMIZE A FLOORING FINISHES OF ADJOINING FLOORING MATERIALS.
 8. CUT OUT ALL TILE WORK SO AS TO MINIMIZE CUTS LESS THAN ONE HALF OF THE FULL SIZE (6-8") WHEREVER IS POSSIBLE.
 9. ALL WALLS TO BE FINISHED WITH POP 1.0 U.S.G.
 10. ALL DOOR FRAMES TO BE FINISHED WITH POP 1.0 EXCEPT LATH WITH GIBBS LATH TO BE POP 1.0.
 11. ALL VISIBLE SURFACES SHALL BE FINISHED WITH POP 1.0 SPECIALLY INDICATED OR NOT. CONFIRM FINISH WITH ARCHITECT PRIOR TO PROCEEDING.
 12. REFER TO FINISH PLAN FOR FINISHING OR FULL SCHEDULES.
 13. EXISTING FINISH FLOOR AND FINISH ALL OPEN CABINETS.
 14. MAKE CEILING OF FINISH ADJOINING OTHER MATERIALS OR CEILING SWEEP AND CLEAN AND WITHOUT OVERLAY.
 15. ALL VERTICAL CEILING TO BE FINISHED WITH POP 1.0 U.S.G.
 16. ALL SPOTS TO BE FINISHED WITH POP 1.0 U.S.G.
 17. ALL VERTICAL CEILING SURFACES TO BE R.1. U.S.G.
 18. ALL CEILING TO BE R.1. U.S.G.
 19. ALL CORNER JOISTS TO BE FULL HEIGHT 2X10.
 20. VERIFY ALL WALLS WITH SCHEDULED WALL BOND.

- ### SELECTIVE FINISH PLAN NOTES - TOWER
- SVF-5 Flooring
 - LVT-1 Flooring
 - SVF-1 Flooring
 - LVT-5 Flooring
 - CPT-1 Flooring
 - TER-1 Flooring
 - PT-1 Flooring
 - TER-3 Flooring
 - TER-2 Flooring
 - Floor Transition
 - MT-1 Bath Tiles
 - PT-2 Bath Tiles
 - RB4-2 Wall Base
 - RB4-1 Wall Base
 - SVF4-S Wall Base
 - PT-2 Wall Base
 - TER4-1 Wall Base
 - SVF4-S Wall Base
 - Inside/Outside Trims

FLOORING LEGEND

TER-1	TER-2	TER-3	SVF-1
[Pattern]	[Pattern]	[Pattern]	[Pattern]

ENVIRONMENTS FOR HEALTH ARCHITECTURE

e4h

NOVA LOUDOUN HOSPITAL LANDSCAPE CURATORS

R INSTITUTE HOSPITAL

NO.	DESCRIPTION	DATE
001	ISSUE FOR CONSTRUCTION	09/20/21
002	ISSUE FOR CONSTRUCTION	09/20/21
003	ISSUE FOR CONSTRUCTION	09/20/21
004	ISSUE FOR CONSTRUCTION	09/20/21
005	ISSUE FOR CONSTRUCTION	09/20/21
006	ISSUE FOR CONSTRUCTION	09/20/21
007	ISSUE FOR CONSTRUCTION	09/20/21
008	ISSUE FOR CONSTRUCTION	09/20/21
009	ISSUE FOR CONSTRUCTION	09/20/21
010	ISSUE FOR CONSTRUCTION	09/20/21
011	ISSUE FOR CONSTRUCTION	09/20/21
012	ISSUE FOR CONSTRUCTION	09/20/21
013	ISSUE FOR CONSTRUCTION	09/20/21
014	ISSUE FOR CONSTRUCTION	09/20/21
015	ISSUE FOR CONSTRUCTION	09/20/21
016	ISSUE FOR CONSTRUCTION	09/20/21
017	ISSUE FOR CONSTRUCTION	09/20/21
018	ISSUE FOR CONSTRUCTION	09/20/21
019	ISSUE FOR CONSTRUCTION	09/20/21
020	ISSUE FOR CONSTRUCTION	09/20/21
021	ISSUE FOR CONSTRUCTION	09/20/21
022	ISSUE FOR CONSTRUCTION	09/20/21
023	ISSUE FOR CONSTRUCTION	09/20/21
024	ISSUE FOR CONSTRUCTION	09/20/21
025	ISSUE FOR CONSTRUCTION	09/20/21
026	ISSUE FOR CONSTRUCTION	09/20/21
027	ISSUE FOR CONSTRUCTION	09/20/21
028	ISSUE FOR CONSTRUCTION	09/20/21
029	ISSUE FOR CONSTRUCTION	09/20/21
030	ISSUE FOR CONSTRUCTION	09/20/21
031	ISSUE FOR CONSTRUCTION	09/20/21
032	ISSUE FOR CONSTRUCTION	09/20/21
033	ISSUE FOR CONSTRUCTION	09/20/21
034	ISSUE FOR CONSTRUCTION	09/20/21
035	ISSUE FOR CONSTRUCTION	09/20/21
036	ISSUE FOR CONSTRUCTION	09/20/21
037	ISSUE FOR CONSTRUCTION	09/20/21
038	ISSUE FOR CONSTRUCTION	09/20/21
039	ISSUE FOR CONSTRUCTION	09/20/21
040	ISSUE FOR CONSTRUCTION	09/20/21
041	ISSUE FOR CONSTRUCTION	09/20/21
042	ISSUE FOR CONSTRUCTION	09/20/21
043	ISSUE FOR CONSTRUCTION	09/20/21
044	ISSUE FOR CONSTRUCTION	09/20/21
045	ISSUE FOR CONSTRUCTION	09/20/21
046	ISSUE FOR CONSTRUCTION	09/20/21
047	ISSUE FOR CONSTRUCTION	09/20/21
048	ISSUE FOR CONSTRUCTION	09/20/21
049	ISSUE FOR CONSTRUCTION	09/20/21
050	ISSUE FOR CONSTRUCTION	09/20/21
051	ISSUE FOR CONSTRUCTION	09/20/21
052	ISSUE FOR CONSTRUCTION	09/20/21
053	ISSUE FOR CONSTRUCTION	09/20/21
054	ISSUE FOR CONSTRUCTION	09/20/21
055	ISSUE FOR CONSTRUCTION	09/20/21
056	ISSUE FOR CONSTRUCTION	09/20/21
057	ISSUE FOR CONSTRUCTION	09/20/21
058	ISSUE FOR CONSTRUCTION	09/20/21
059	ISSUE FOR CONSTRUCTION	09/20/21
060	ISSUE FOR CONSTRUCTION	09/20/21
061	ISSUE FOR CONSTRUCTION	09/20/21
062	ISSUE FOR CONSTRUCTION	09/20/21
063	ISSUE FOR CONSTRUCTION	09/20/21
064	ISSUE FOR CONSTRUCTION	09/20/21
065	ISSUE FOR CONSTRUCTION	09/20/21
066	ISSUE FOR CONSTRUCTION	09/20/21
067	ISSUE FOR CONSTRUCTION	09/20/21
068	ISSUE FOR CONSTRUCTION	09/20/21
069	ISSUE FOR CONSTRUCTION	09/20/21
070	ISSUE FOR CONSTRUCTION	09/20/21
071	ISSUE FOR CONSTRUCTION	09/20/21
072	ISSUE FOR CONSTRUCTION	09/20/21
073	ISSUE FOR CONSTRUCTION	09/20/21
074	ISSUE FOR CONSTRUCTION	09/20/21
075	ISSUE FOR CONSTRUCTION	09/20/21
076	ISSUE FOR CONSTRUCTION	09/20/21
077	ISSUE FOR CONSTRUCTION	09/20/21
078	ISSUE FOR CONSTRUCTION	09/20/21
079	ISSUE FOR CONSTRUCTION	09/20/21
080	ISSUE FOR CONSTRUCTION	09/20/21
081	ISSUE FOR CONSTRUCTION	09/20/21
082	ISSUE FOR CONSTRUCTION	09/20/21
083	ISSUE FOR CONSTRUCTION	09/20/21
084	ISSUE FOR CONSTRUCTION	09/20/21
085	ISSUE FOR CONSTRUCTION	09/20/21
086	ISSUE FOR CONSTRUCTION	09/20/21
087	ISSUE FOR CONSTRUCTION	09/20/21
088	ISSUE FOR CONSTRUCTION	09/20/21
089	ISSUE FOR CONSTRUCTION	09/20/21
090	ISSUE FOR CONSTRUCTION	09/20/21
091	ISSUE FOR CONSTRUCTION	09/20/21
092	ISSUE FOR CONSTRUCTION	09/20/21
093	ISSUE FOR CONSTRUCTION	09/20/21
094	ISSUE FOR CONSTRUCTION	09/20/21
095	ISSUE FOR CONSTRUCTION	09/20/21
096	ISSUE FOR CONSTRUCTION	09/20/21
097	ISSUE FOR CONSTRUCTION	09/20/21
098	ISSUE FOR CONSTRUCTION	09/20/21
099	ISSUE FOR CONSTRUCTION	09/20/21
100	ISSUE FOR CONSTRUCTION	09/20/21

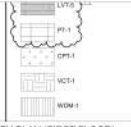

ISSAL PROJECT NUMBER 42610 DATE 09/20/21 SHEET TITLE AND NUMBER A5.1B FINISH PLAN - FIRST FLOOR - AREA B

- MAT-1 109.3 SQ FT
- TER-1,2,3: Flooring 483.8 SQ FT
- TER-3: Flooring 69.0 SQ FT
- TER-1: Flooring 177.6 SQ FT
- Floor Transition 7.1 FT
- Inside/Outside Trims 17.0 EA
- RB4-1 Wall Base 32.0 FT
- TER4-1 Wall Base 157.1 FT

FINISH PLAN - GENERAL NOTES

1. THE SOLE INTENT OF THIS DOCUMENT IS TO DEFINE THE COLOR AND OR FINISH OF THE MATERIALS SPECIFIED. IT IS THE RESPONSIBILITY OF THE CONTRACTOR TO NOTIFY AN ARCHITECTURE OF ANY DISCREPANCIES BETWEEN THE FINISH SCHEDULES.
2. REFER TO THE ARCHITECTURAL SPECIFICATIONS FOR IMPORTANT INFORMATION REGARDING THE SPECIFIED FINISH MATERIALS AND MANUFACTURERS.
3. REFER TO THE FINISH PLAN FOR ACCENT PAINT AND WALL PROTECTION LOCATIONS.
4. INSTALLED TRIM MUST BEARING OR PROTECTIVE FLOORING REGULATION TO DESIGNER FOR APPROVAL AT SUBMITTAL STAGE.
5. REFER TO THE FINISH PLAN FOR COLOR CODE OR SUBMIT SUBJECT TO DESIGNER.
6. NOTIFY THE DESIGNER IMMEDIATELY FOR ANY DISCREPANCIES. CONTRACTOR MUST CONFIRM THE DIMENSION AND REPORT DISCREPANCIES TO THE ARCHITECT.
7. ALL FLOOR JOINTS TO USE STRAIGHT LAMINATED JOINTS, PLUGS AND LEVEL. ALIGN ALL FLOOR JOINTS TO THE STRAIGHT LAMINATED JOINTS AND TO THE STRAIGHT LAMINATED JOINTS.
8. CLEAN FLOORS AS REQUIRED TO MAINTAIN A FLOORING FINISHED SURFACE OF LAMINATED FLOORING MATERIALS.
9. LAY OUT ALL TILE WORK SO AS TO MINIMIZE CUTS (LESS THAN ONE HALF OF THE FULL SIZE 60"x12" DIMENSIONS) TO SPINDLES.
10. ALL WALLS TO BE FINISHED WITH POP-U-GOIN.
11. ALL DOOR FRAMES TO BE FINISHED WITH POP-U-GOIN WITH GREEN GATES TO BE FIT TO.
12. ALL VISIBLE SURFACES SHALL BE FINISHED WITHER SPECIALLY INDICATED OR NOT. CONFIRM FINISH WITH ARCHITECT PRIOR TO PROCEEDING.
13. REFER TO FINISH PLAN FOR FINISH OR FULL INTERFERENCES.
14. EXTEND FINISH FLOOR UNDERNEATH ALL OPEN CABINETS.
15. MAKE CEILING FINISH ADJUSTING OTHER MATERIALS OR COLOR SWATCH AND COLOR AND WITHOUT DELAY.
16. ALL ORIGINAL CEILING TO BE FINISHED WITH POP-U-GOIN.
17. ALL SPOFFS TO BE FINISHED WITH POP-U-GOIN.
18. ALL VERTICAL CASINGWORK SURFACES TO BE R.A. U.S.G.B.
19. ALL CEILING TO BE R.A. U.S.G.B.
20. ALL CORNER CASING TO BE R.A. U.S.G.B.
21. VERIFY ALL MATERIALS WITH SCHEDULED WALL BANK.

SELECTIVE FINISH PLAN NOTES - TOWER

- 1. REFER TO FINISH PLAN FOR FINISH OR FULL INTERFERENCES.
- 2. REFER TO FINISH PLAN FOR FINISH OR FULL INTERFERENCES.
- 3. REFER TO FINISH PLAN FOR FINISH OR FULL INTERFERENCES.
- 4. REFER TO FINISH PLAN FOR FINISH OR FULL INTERFERENCES.

FLOORING LEGEND

- TER-1
- TER-2
- TER-3
- SWF-1
- SWF-2
- SWF-3
- SWF-4
- SWF-5
- LVT-1
- LVT-2
- LVT-3
- LVT-4
- LVT-5
- LVT-6
- PT-1
- CPE-1
- VCT-1
- WDM-1

KEY PLAN (FIRST FLOOR)

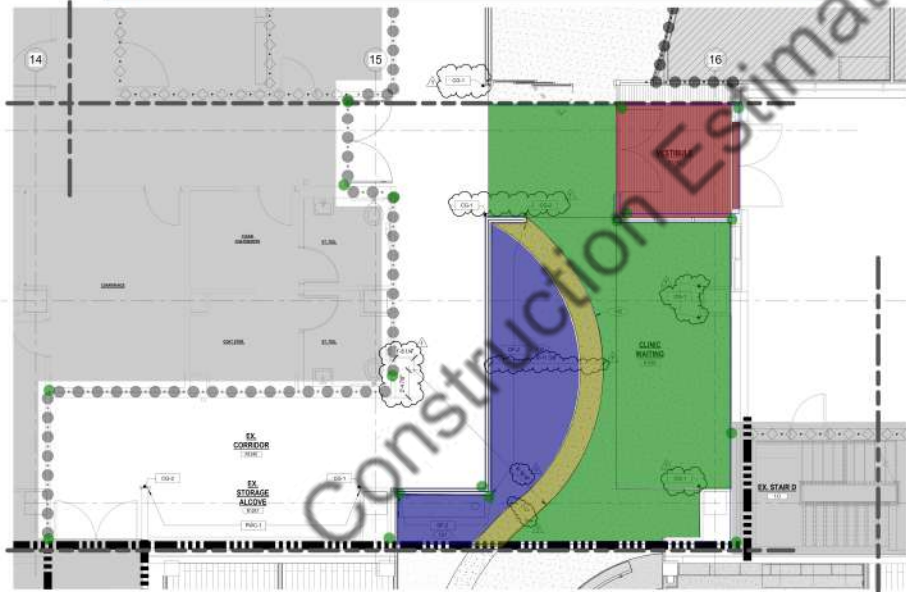
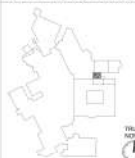

1 FIRST FLOOR FINISH PLAN - AREA B2

ENVIRONMENTS FOR HEALTH ARCHITECTURE
 10001 FALCON DRIVE, SUITE 100, FALLS CHURCH, VA 22034
 703.441.1111

INOVA LOUDOUN HOSPITAL
 LANDSCAPE COURTS

INOVA LOUDOUN HOSPITAL
INOVA SCHAR CANCER INSTITUTE
AT INOVA LOUDOUN HOSPITAL

REV	DESCRIPTION	DATE
1	FINAL RELEASE	09/05/21
2	FINAL RELEASE	09/08/21

SEAL PROJECT NUMBER: 426410
 DATE: 09/08/21
 SHEET TITLE AND NUMBER: **A5.1B-2**
 FINISH PLAN - FIRST FLOOR - AREA B2

KEY TAG	MANUFACTURER	STYLE/SERIES	COLOR/FINISH	DESCRIPTION	SIZE	REMARKS	REVISION
ACU1-A	AMERTRON	1885 ULTIMA REAL TORQUE SQUARE LAY IN	WHITE	SPECIFIED W/ PULLER KL 1/4" GRID	24" x 24"	TYPICAL	1
AC1-B	AMERTRON	1885 ULTIMA REAL TORQUE SQUARE LAY IN	WHITE	SPECIFIED W/ PULLER KL 1/4" GRID	24" x 24"	EXISTING LORRY TO CONNECT TO INDOOR SWATING	1
AC1-C	AMERTRON	1885 ULTIMA REAL TORQUE SQUARE LAY IN	WHITE	SPECIFIED W/ PULLER KL 1/4" GRID	24" x 24"	EXISTING LORRY TO CONNECT TO INDOOR SWATING	1
AC1-D	AMERTRON	1885 ULTIMA REAL TORQUE SQUARE LAY IN	WHITE	SPECIFIED W/ PULLER KL 1/4" GRID	24" x 24"	EXISTING LORRY TO CONNECT TO INDOOR SWATING	1
AC1-E	AMERTRON	1885 ULTIMA REAL TORQUE SQUARE LAY IN	WHITE	SPECIFIED W/ PULLER KL 1/4" GRID	24" x 24"	EXISTING LORRY TO CONNECT TO INDOOR SWATING	1
AC1-F	AMERTRON	1885 ULTIMA REAL TORQUE SQUARE LAY IN	WHITE	SPECIFIED W/ PULLER KL 1/4" GRID	24" x 24"	EXISTING LORRY TO CONNECT TO INDOOR SWATING	1
AC1-G	AMERTRON	1885 ULTIMA REAL TORQUE SQUARE LAY IN	WHITE	SPECIFIED W/ PULLER KL 1/4" GRID	24" x 24"	EXISTING LORRY TO CONNECT TO INDOOR SWATING	1
AC1-H	AMERTRON	1885 ULTIMA REAL TORQUE SQUARE LAY IN	WHITE	SPECIFIED W/ PULLER KL 1/4" GRID	24" x 24"	EXISTING LORRY TO CONNECT TO INDOOR SWATING	1
AC1-I	AMERTRON	1885 ULTIMA REAL TORQUE SQUARE LAY IN	WHITE	SPECIFIED W/ PULLER KL 1/4" GRID	24" x 24"	EXISTING LORRY TO CONNECT TO INDOOR SWATING	1
AC1-J	AMERTRON	1885 ULTIMA REAL TORQUE SQUARE LAY IN	WHITE	SPECIFIED W/ PULLER KL 1/4" GRID	24" x 24"	EXISTING LORRY TO CONNECT TO INDOOR SWATING	1
AC1-K	AMERTRON	1885 ULTIMA REAL TORQUE SQUARE LAY IN	WHITE	SPECIFIED W/ PULLER KL 1/4" GRID	24" x 24"	EXISTING LORRY TO CONNECT TO INDOOR SWATING	1
AC1-L	AMERTRON	1885 ULTIMA REAL TORQUE SQUARE LAY IN	WHITE	SPECIFIED W/ PULLER KL 1/4" GRID	24" x 24"	EXISTING LORRY TO CONNECT TO INDOOR SWATING	1
AC1-M	AMERTRON	1885 ULTIMA REAL TORQUE SQUARE LAY IN	WHITE	SPECIFIED W/ PULLER KL 1/4" GRID	24" x 24"	EXISTING LORRY TO CONNECT TO INDOOR SWATING	1
AC1-N	AMERTRON	1885 ULTIMA REAL TORQUE SQUARE LAY IN	WHITE	SPECIFIED W/ PULLER KL 1/4" GRID	24" x 24"	EXISTING LORRY TO CONNECT TO INDOOR SWATING	1
AC1-O	AMERTRON	1885 ULTIMA REAL TORQUE SQUARE LAY IN	WHITE	SPECIFIED W/ PULLER KL 1/4" GRID	24" x 24"	EXISTING LORRY TO CONNECT TO INDOOR SWATING	1
AC1-P	AMERTRON	1885 ULTIMA REAL TORQUE SQUARE LAY IN	WHITE	SPECIFIED W/ PULLER KL 1/4" GRID	24" x 24"	EXISTING LORRY TO CONNECT TO INDOOR SWATING	1
AC1-Q	AMERTRON	1885 ULTIMA REAL TORQUE SQUARE LAY IN	WHITE	SPECIFIED W/ PULLER KL 1/4" GRID	24" x 24"	EXISTING LORRY TO CONNECT TO INDOOR SWATING	1
AC1-R	AMERTRON	1885 ULTIMA REAL TORQUE SQUARE LAY IN	WHITE	SPECIFIED W/ PULLER KL 1/4" GRID	24" x 24"	EXISTING LORRY TO CONNECT TO INDOOR SWATING	1
AC1-S	AMERTRON	1885 ULTIMA REAL TORQUE SQUARE LAY IN	WHITE	SPECIFIED W/ PULLER KL 1/4" GRID	24" x 24"	EXISTING LORRY TO CONNECT TO INDOOR SWATING	1
AC1-T	AMERTRON	1885 ULTIMA REAL TORQUE SQUARE LAY IN	WHITE	SPECIFIED W/ PULLER KL 1/4" GRID	24" x 24"	EXISTING LORRY TO CONNECT TO INDOOR SWATING	1
AC1-U	AMERTRON	1885 ULTIMA REAL TORQUE SQUARE LAY IN	WHITE	SPECIFIED W/ PULLER KL 1/4" GRID	24" x 24"	EXISTING LORRY TO CONNECT TO INDOOR SWATING	1
AC1-V	AMERTRON	1885 ULTIMA REAL TORQUE SQUARE LAY IN	WHITE	SPECIFIED W/ PULLER KL 1/4" GRID	24" x 24"	EXISTING LORRY TO CONNECT TO INDOOR SWATING	1
AC1-W	AMERTRON	1885 ULTIMA REAL TORQUE SQUARE LAY IN	WHITE	SPECIFIED W/ PULLER KL 1/4" GRID	24" x 24"	EXISTING LORRY TO CONNECT TO INDOOR SWATING	1
AC1-X	AMERTRON	1885 ULTIMA REAL TORQUE SQUARE LAY IN	WHITE	SPECIFIED W/ PULLER KL 1/4" GRID	24" x 24"	EXISTING LORRY TO CONNECT TO INDOOR SWATING	1
AC1-Y	AMERTRON	1885 ULTIMA REAL TORQUE SQUARE LAY IN	WHITE	SPECIFIED W/ PULLER KL 1/4" GRID	24" x 24"	EXISTING LORRY TO CONNECT TO INDOOR SWATING	1
AC1-Z	AMERTRON	1885 ULTIMA REAL TORQUE SQUARE LAY IN	WHITE	SPECIFIED W/ PULLER KL 1/4" GRID	24" x 24"	EXISTING LORRY TO CONNECT TO INDOOR SWATING	1

NOTE: ALL INTERIOR FINISHES SHALL BE CLASS A IN ACCORDANCE WITH IBC/USBC CHAPTER 8 FINISH MATERIAL REQUIREMENTS (TABLE 803.9)

ENVIRONMENTS FOR HEALTH ARCHITECTURE

e4n

NOVA LOUDOUN HOSPITAL LANDSCAPE COURTS

NOVA LOUDOUN HOSPITAL

NOVA SCHAR CANCER INSTITUTE

AT NOVA LOUDOUN HOSPITAL

KEY	DESCRIPTION	DATE
1	ISSUE FOR PERMIT	06/20/21
2	REVISION	06/21/21
3	REVISION	06/22/21

ISSUE FOR PERMIT

NOVA LOUDOUN HOSPITAL

NOVA SCHAR CANCER INSTITUTE

AT NOVA LOUDOUN HOSPITAL

A11.1

KEY TO FINISHES

